



PRODUCT CHANGE NOTIFICATION

PRODUCT CHANGE NOTIFICATION NUMBER: PC000017

PCN DATE: August 1, 2022

This notice is to inform you about the following changes to the listed Stewart Connector products. For any further questions about these changes, please contact your Stewart Connector sales contact, or customer service representative.

PARTS AFFECTED:

All standard Stewart Connector part numbers produced in Stewart's North American manufacturing sites in Mexico and Pennsylvania

GENERAL PRODUCT DESCRIPTION:

Standard Stewart Connector product offering

REASON FOR CHANGE:

Updated label specification in-line with ECIA industry guidelines

DESCRIPTION OF CHANGES:

See attached file with details. This change will not affect the product in any way. The implementation will be handled as a running change so products labeled under the old specification will be shipped until inventory is depleted.

ESTIMATED IMPLEMENTATION DATE:

9/1/2022

SIGNATURE:

Derek Imschweiler
General Manager
Stewart Connector

11118 Susquehanna Trail South
Glen Rock, PA
17327, USA

T 717.235.7512
stewartconnector.com

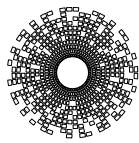

stewart
CONNECTOR
a bel group

1118 Susquehanna Trail South
Glen Rock, PA 17327-9199
(717) 235-7512

http://www.stewartconnector.com

**PRODUCT
CHANGE
NOTIFICATION**

DATE	REV
7-27-22	A0

PRODUCT CHANGE NOTIFICATION

OLD DESIGN

PART NUMBER

QUANTITY

COUNTRY OF ORIGIN

Stewart Connector		1118 Susquehanna Trail South Glen Rock, PA 17327-9199	
PN (P)		SS-37000-007	
QTY (Q)		5000	
<small>One or more U.S. patents may apply to this product. For details, please visit: HTTP://BELFUSE.COM/STEWART/STEWART_PATENTS/</small>			
W/O #	1234567890	Matl Lot #	12345
Desc :	UNIBODY PLUG W/CONTACTS	Date Code:	2135
ROI PN		SS-37000-007	
QTY	5000	DEPT	0000
STA	000	EMP	0000
TOOL	0	MOLD	000
MADE IN USA		DATE PACKED 07/27/22	

DATE CODE

NEW DESIGN

PART NUMBER

DATE CODE

LOT CODE

COUNTRY OF ORIGIN

QUANTITY

(1P) Supplier Part Number: SS-37000-007			
(10D) Date Code: 2135		(4L) Country of Origin: CN	
(1T) Lot Code: N/T		(Q) Quantity: 5000	
Stewart Connector		1118 Susquehanna Trail South Glen Rock, PA 17327-9199	
Desc :	UNIBODY PLUG W/CONTACTS	STA	000
PN	SS-37000-007	TOOL	0
SHORT PN	SS-37000-007	DEPT	0000
WO #	1234567890	EMP	0000
DATE PACKED	07/27/22	MOLD	000
<small>One or more U.S. patents may apply to this product. For details, please visit: HTTP://BELFUSE.COM/STEWART/STEWART_PATENTS/</small>			

1. LABEL DESIGNED TO FOLLOW EIGP 114.2018 SPECIFICATION
2. MARKED INFORMATION HAS BEEN MOVED TO THE TOP WITH BARCODES AND TEXT
3. ROI PN WAS RENAMED TO SHORT PN
4. MATL LOT # WAS REMOVED
5. LOT CODE WAS ADDED AND WILL STATE N/T WHEN IT IS NOT TRACKED
6. 2D BARCODE WAS ADDED AND CONTAINS ALL BARCODE INFORMATION ON TOP HALF OF LABEL

SHEET 1 OF 1

THIS DRAWING AND THE SUBJECT MATTER SHOWN THEREON ARE CONFIDENTIAL AND THE PROPRIETARY PROPERTY OF STEWART CONNECTOR AND SHALL NOT BE REPRODUCED, COPIED, OR USED IN ANY MANNER WITHOUT PRIOR WRITTEN CONSENT OF STEWART CONNECTOR. ONE OR MORE U.S. PATENTS MAY APPLY TO THIS PRODUCT. FOR DETAILS, PLEASE VISIT: [HTTP://BELFUSE.COM/STEWART/STEWART_PATENTS/](http://BELFUSE.COM/STEWART/STEWART_PATENTS/)

THIRD ANGLE PROJECTION

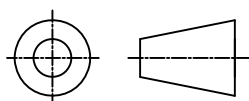

DIMENSIONS SHOWN ARE SUBJECT TO CHANGE WITHOUT NOTICE

DIMENSIONS: INCHES [METRIC]

UNLESS OTHERWISE SPECIFIED
TOLERANCES ARE ±.005 [0.13]
ANGLES ARE ± 1°

DRN BY:	JMM	DATE	7-27-22
APPD BY:	GWL	DATE	7-27-22
DWG NO.	PC000017	REV.	A0

Item number	BM-1ST010F-01	SS-12400-004	SS-39500-001	SS-6488S-A-FLS-01
937-SP-301010-2PC-A192	BM-1ST015F-01	SS-30100-019	SS-39500-002	SS-6488S-A-FLS-50
937-SP-301010R	BM-1ST020F-01	SS-310606-3-60	SS-52400-001	SS-6488S-A-NF
937-SP-3046	BM-1ST025F-01	SS-310606-5	SS-52400-002	SS-6488S-A-NF-01-M07
937-SP-3066R	BM-1ST030F-01	SS-311010-1	SS-52400-003	SS-6488S-A-NF-1
937-SP-3066R-OST	BM-5AJPK001F	SS-311010-26	SS-60400-001	SS-650810-A-FLS
937-SP-3088	BM-5AJPK003F	SS-311515-26	SS-60400-003	SS-650810-A-NF
937-SP-3088R	BM-5AJPK005F	SS-37000-002	SS-60400-004	SS-650810-A-NF-50
937-SP-360606-A151	BM-5AJPK007F	SS-37000-006	SS-60400-006	SS65100-009F
937-SP-360808-A108	BM-5AJPK025F	SS-37000-007	SS-60400-021	SS65100-010F
937-SP-360808-A218	BM-6AJPK001F	SS-37000-009	SS-60400-022	SS65100-031F
937-SP-361010-031-A108	BM-MAMD010M	SS-37200-028	SS-60400-025	SS65100-066F
937-SP-361010-A161	BM-MAMD020M	SS-39100-002	SS-60400-028	SS65100-068F
940-SP-301010R	BM-MAMD050M	SS-39100-004	SS-611010-LF-P-1-4/6	SS-651010-A-NF
940-SP-3046R	BM-MAMM003F	SS-39100-005	SS-611010-TLF-P-26-4/6	SS-651010-A-NF-K2
940-SP-3066	BM-MAMM007F	SS-39100-008	SS-611515-TLF-P-26-4/6	SS65400-003F
940-SP-3066-OST	BM-MAMM010M	SS-39100-011	SS63600-005F	SS-6544-NF
940-SP-3066R	BM-MAMM015F	SS-39100-021	SS-640810-A-NF-A111	SS71800-003F
940-SP-3088	BM-MAMM020M	SS-39100-029	SS-640810S-A-NF	SS71800-007F
940-SP-3088-B25	BM-MAMM030F	SS-39100-039	SS-640810S-A-NF-A111	SS71800-022F
940-SP-3088R	BM-MAMM030M	SS-39100-045	SS64100-002F	SS71800-023F
940-SP-3088R-A133	BM-MAMM100M	SS-39100-049	SS64100-042F	SS71800-132F
940-SP-3088R-K1	BM-MARM003F	SS-39100-066	SS64100-043F	SS-7188-NF
940-SP-360606-A151	BM-MARM007F	SS-39200-006	SS-64100-082	SS-7188S-A-FLS
940-SP-360808-031-A221	BM-MARM010M	SS-39200-010	SS64100-083F	SS-7188S-A-FLS-01
940-SP-360808-A108	BM-MARM015F	SS-39200-011	SS-641010-A-NF-A111	SS-7188S-A-NF
940-SP-360808-A161	BM-MARM020M	SS-39200-012	SS-641010-NF	SS-7188S-A-NF-50
940-SP-360808-A217	BM-MARM030F	SS-39200-020	SS-641010-NF-A115	SS-7188S-A-NF-K1-50
940-SP-361010-A108	BM-MARM030M	SS-39200-022	SS-641010-NF-A414	SS-7188V-A-NF
940-SP-361010-A161	BM-MARM100M	SS-39200-023	SS-641010-NF-RMK4	SS-7188V-A-NF-50
943-SP-370808M2	BM-R6UE001F	SS-39200-024	SS-641010S-A-NF	SS-74500-043
943-SP-370808M2-A363	BM-R6UE005F	SS-39200-027	SS-641010S-A-NF-A111	SS-74800-135
943-SP-370808M2-A381	CA001015CS	SS-39200-030	SS-641010S-A-NF-K1	SS-79100-003
943-SP-370808SM2-A217	CA001016CS	SS-39200-032	SS-641010S-A-NF-RMK4	SS-79100-011
943-SP-370808SM2-A218	CA001018CS	SS-39200-034	SS-641010S-A-NF-RMK4R	
943-SP-370808SM2-A264	CA001021G100	SS-39200-054	SS-6448-NF-A01	
943-SP-370808SM2-A380	CA001021K100	SS-39200-056	SS-6466-NF-SJ	
943-SP-370808SM2-A426	CA001028	SS-39200-063	SS64800-012F	
943-SP-370808SM2-A467	SS-12000-010	SS-39200-090	SS64800-031F	
BM-1BJPK003F	SS-12000-017	SS-39200-098	SS64800-077F	
BM-1BJPK015F	SS-12000-018	SS-39300-001	SS-64800-084	
BM-1ST001F-01	SS-12000-019	SS-39300-002	SS-6488-FLS	
BM-1ST003F-01	SS-12000-020	SS-39300-010	SS-6488-NF	
BM-1ST005F-01	SS-12000-023	SS-39400-005	SS-6488-NF-A431	
BM-1ST007F-01	SS-12400-001	SS-39400-008	SS-6488S-A-FLS	